



6 Ardoch Path

Newmains, Wishaw, ML2 9HG

Offers over £114,999

Set in a popular yet quiet area of Newmains, Wishaw, this lovely spacious and bright end terraced villa presents an excellent opportunity to purchase an immaculate family home.

The accommodation comprises entrance porch, reception hallway, large lounge, modern kitchen, two great sized double bedrooms with storage and bathroom.

Further benefits include landscaped enclosed well maintained gardens to front and rear, double glazing and gas central heating.

Over the past two years the property has also benefitted from a new tiled roof, PVC fascia boards and gutters, combi boiler and radiators. It has been rewired, with the kitchen and bathroom being upgraded during that time.

Newmains is within close proximity to the town of Wishaw whilst offering local amenities such as shops and schools. The property is also well-placed for access to larger towns such as Motherwell, Hamilton, and Airdrie. The area is well-served by public transport and there is easy access to the main motorway networks including the M8 which connects the area to Glasgow and Edinburgh, and the M74 and M80.

EPC C

Viewing

Please contact our Pomphreys Properties Ltd Office on 01698373365 if you wish to arrange a viewing appointment for this property or require further information.

- Immaculate and Spacious End Terraced Villa
- Large Bright Lounge
- Modern Kitchen & Bathroom
- Enclosed Gardens to front and rear
- Two large double bedrooms with storage



Floor Plan

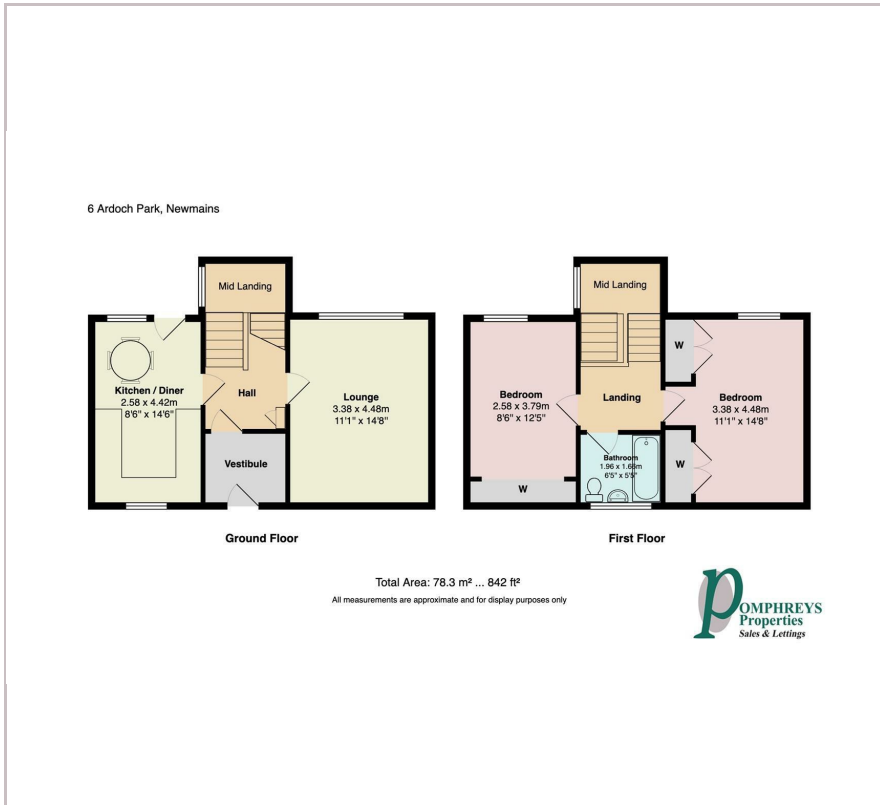

Area Map



Energy Efficiency Graph



These particulars, whilst believed to be accurate are set out as a general outline only for guidance and do not constitute any part of an offer or contract. Intending purchasers should not rely on them as statements of representation of fact, but must satisfy themselves by inspection or otherwise as to their accuracy. No person in this firm's employment has the authority to make or give any representation or warranty in respect of the property.